



SIRENA

Quick Start Guide Please Read Before Operating Machine

Please check the contents of your box for the following items:

- 1 Starbucks Sirena
- 1 Portafilter
- 1 Power Cord
- 1 User Manual
- 1 Plastic Support Peg*
- 1 Rubber Gasket Adapter*
- 1 Ground Coffee Filter*
- 1 Pod Filter

* These components are pre-assembled inside the portafilter.

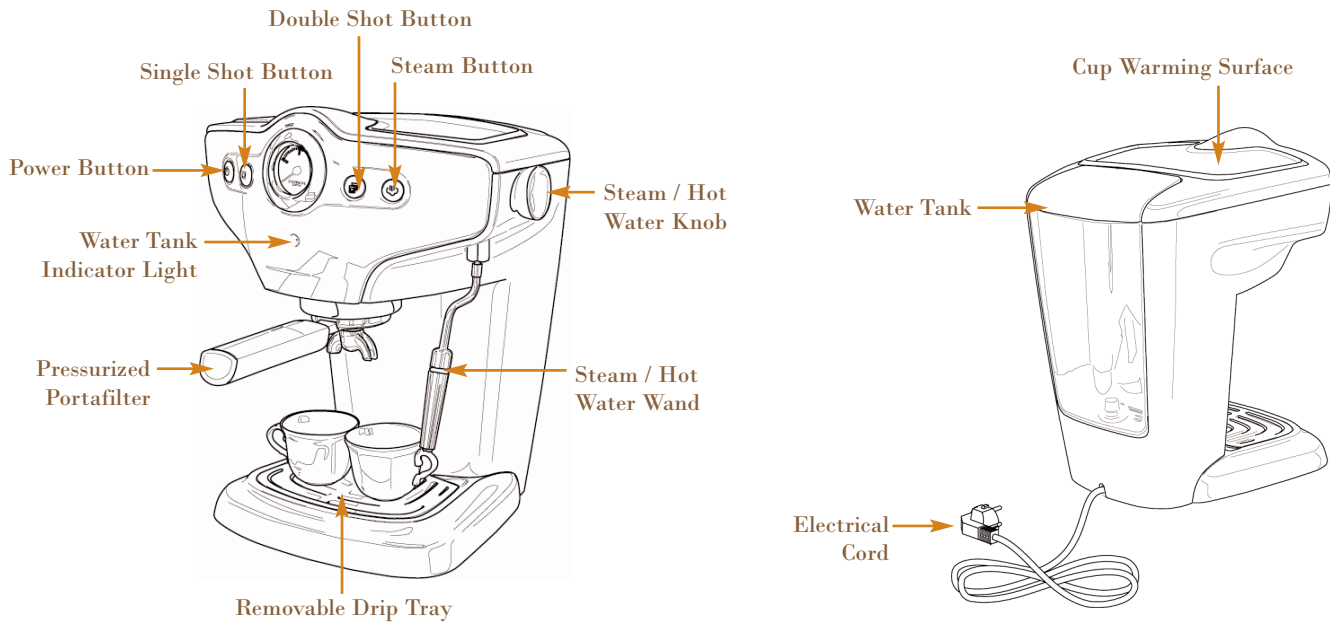

DO NOT turn machine on until water has been added to water tank.

When using pre-ground coffee, you must first insert the plastic support peg into the Portafilter along with the rubber gasket adapter, and then insert the ground coffee filter.

or

To use a single shot pod, please insert the ESE pod filter basket directly into the Portafilter

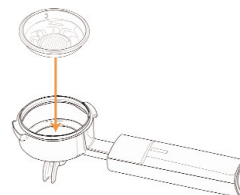
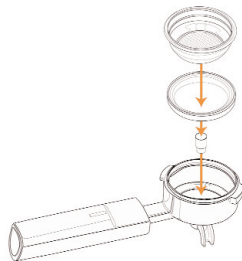

The ability to enjoy delicious espresso drinks has never been easier. Get ready to experience pure espresso nirvana.

Follow these five simple steps:

1. Attach Power Cord
2. Add Water
3. Plug in Sirena
4. Prime Sirena
5. Add Ground Coffee

Step 1 - Attach Power Cord

- Connect the power cord to the machine. (see Figure 1)

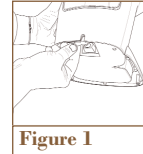

Step 2 - Add Water

- Remove water tank and fill tank with water. (see Figure 2)
- Replace water tank on back of machine.

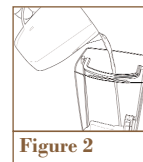

Step 3 - Plug in Sirena

- Plug power cord into outlet.

Step 4 - Prime Sirena

- Point steam / hot water wand over the drip tray
- Turn machine on by pushing the power button
- The blue water indicator light will start blinking quickly. This means the machine needs to be primed.
- Turn the steam / hot water knob clockwise
- Allow 8 oz. of water to flow from the steam / hot water wand for about 30 seconds (see Figure 3).
- Turn the knob counter-clockwise to stop water flow
- The shot button lights will start blinking slowly. This means the machine is warming up. The blinking will stop when the machine is warmed-up and ready to use.

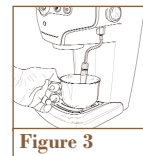

Step 5 - Add Ground Coffee

- Place ground coffee inside Portafilter. (see Figure 4)
(Use one scoop for single shot, or two scoops for double.)
- Place Portafilter in the brew head by pushing it upwards and turning right.

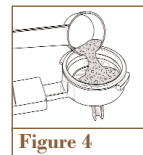

Now you are ready to enjoy delicious freshly brewed espresso from your new Starbucks Sirena.

Simply

- Place cup under brew head
- Press the shot button (either single or double)
- Experience pure espresso nirvana

It is our wish that you will discover the every day joys of espresso with your new Sirena. Should you ever have any questions or concerns, please do not hesitate to contact us, we love to hear from our customers. We have a highly trained staff of coffee experts who will be happy to guide you on your journey to experiencing the perfect cup of espresso.



Please read the entire Quick Start Guide before operating machine. For more detailed instructions on how to operate the Sirena, please refer to the user manual. If further assistance is needed, please contact Saeco Customer Service.

Please do not return this machine to Starbucks.

Saeco Customer Service: 1-800-933-7876 or visit: www.saeco-usa.com

For parts and accessories, visit: www.saecooutlet.com

For more information, visit: www.starbucks.com